

# GRAVELY

Continue its program of quality and design improvement, the manufacturer reserves the right to change specifications, design or prices without notice and without incurring obligation.

## ILLUSTRATED PARTS LIST

SICKLE MOWER

Consist Of

42" Cutterbar	10287E1
(3" Knives)	10281E1
Sickle Mower Drive	5-15-75
Effective Date	21018L1
Form Number	

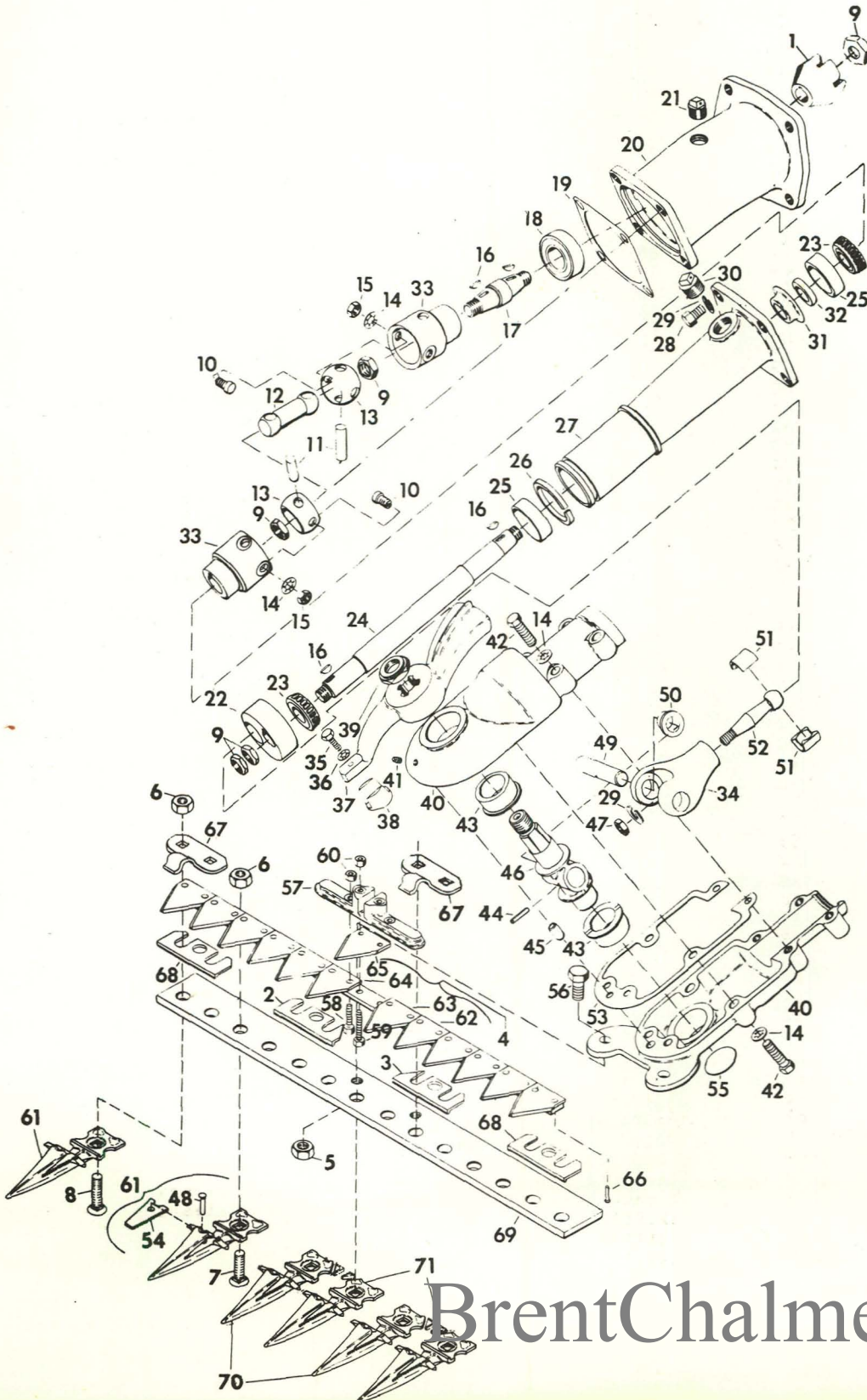

BrentChalmers.com

ITEM NO.	PART NO.	DESCRIPTION
1	19592P1	Clutch, Dog P.T.O.
2	20745P1	Plate, Wear R. H.
3	20746P1	Plate, Wear L. H.
4	10293A1	Knife, Assembly 42-3" Knives
5	120238	Nut, Jam 1/2-13
6	271501	Nut, Hex 7/16-14
7	3303P1	Bolt, Plow 7/16-14 x 1-1/4 No. 3 Hd
8	3304P1	Bolt, Guard Lg.
9	19918P1	Nut, Lock 5/8-24
10	13599P1	Stud, Pivot
11	13601P1	Pin, Pivot
12	13602P1	Link
13	13600P1	Ring, Center
14	138542	Washer, Lock 3/8 Int Tooth
15	13627P1	Nut, Lock Esna 3/8-24
16	124549	Key, Woodruff 3/16 x 3/4 Hard No. 9
17	13596P1	Shaft, Stud
18	13597P1	Bearing, Ball .984 x 2.047 x .590
19	5056P1	Gasket, Attachment
20	3197P1	Housing, Universal
21	13408P1	Plug, 1/2 Sq. Hd.
22	13605P1	Disc, Crank
23	13594P1	Bearing, Roller Cone
24	13603P1	Crankshaft
25	13595P1	Bearing, Roller Race
26	3173P1	Cork Seal
27	13604P1	Column, Drive
28	180173	Bolt, Hex 1/2-13 x 1
29	120384	Washer, Lock 1/2 Sp.
30	13607P1	Plug, 3/4 N.P.T. Sq. Hd. Pipe Vented
31	3151P1	Retainer, Oil Seal
32	12987P1	Seal, Oil Bearing Cap
33	13598P1	Cup, Universal
34	10442A1	Crank Yoke Assembly
35	3154P1	Bolt, Special 1/4-28 x 1 Gr. 8
36	120423	Washer, Lock 1/4 Int. Tooth
37	3117P1	Lever, Knife Actuating
38	3182P1	Tip, Wearing
39	13619P1	Nut, Lock 1-14 Washer Insert
40	10476A1	Crank Housing Assembly
41	103877	Plug, Pipe 1/8 In. Sq. Hd. Steel
42	180129	Bolt, Hex 3/8-16 x 1-7/8
43	13550P1	Bushing, Flange Lever Shaft
44	9414525	Pin, Spring 3/16 x 1-3/8
45	3184P1	Pin, Dowel 3/8 x 3/4
46	13606P1	Shaft, Actuating Lever
47	124934	Nut, Jam 1/2-20
48	14119P1	Rivet, Single
49	3176P1	Pin Knuckle
50	3178P1	Bushing, Flange Knuckle Pin
51	3145P1	Bearing, Ball Stud
52	3144P1	Stud, Ball
53	3191P1	Gasket, Housing
54	14118P1	Plate, Single Ledger
55	3198P1	Plug, Expansion
56	180175	Bolt, Hex 1/2-13 x 1-1/4
57	3308P1	Bracket, Drive Knife
58	181570	Bolt, Hex 1/4-28 x 1-1/8
59	181577	Bolt, Hex 1/4-28 x 1-3/4
60	454750	Nut, Lock 1/4-28 Washer Insert Hex
61	14902A1	Finger, Shear Assembly
62	3206P1	Knife, Section
63	13609P1	Knife, Box Left Section
64	13610P1	Knife, Box Right Section
65	13608P1	Knife, Box Center Section
66	189290	Rivet, Knife
67	3309P1	Clip, Knife
68	20504P1	Plate, Wear
69	3301P1	Bar, Guard
70		Remove corner of item 61 as shown for clearance
71		Remove corner of item 61 as shown for clearance
NS	10295A1	Knife Assembly 60" 3" Knives
NS	13612P1	Back, Knife 60"
NS	14117P1	Bar, Guard 60"